

Static control for hazardous areas

# Don't Risk It! Earth It!

## Earth-Rite *RTR*™

(PATENT PENDING)

### Tri-Mode Technology

#### Static Earthing for Road Tankers



#### Road Tanker Recognition

Only allows product transfer when system is connected to road tanker

#### Positive Earth Recognition

Automatically confirms positive static earth connection

#### Earth Connection Monitoring

Continuously monitors clamp and earth connection during transfer

The **Earth-Rite *RTR*™** ensures the highest possible levels of safe, positive earthing for road tankers during flammable transfer operations. Unlike conventional systems, the Earth-Rite *RTR*™ provides failsafe confirmation of the static earth condition using patented Intrinsically Safe Electronics.

**ATEX**



**SIL 2**

**IECEx**



**Cenelectrex®**

**Newson-Gale Ltd.** | For over 25 years Newson Gale has been supplying the chemical and processing industry worldwide with its market leading Cenelectrex® family of products ensuring people and plant are protected from static related fires and explosions.

**www.newson-gale.co.uk**  
**tel: +44 (0) 115 940 7500**

# Earth-Rite *RTR*™

## Tri-Mode Technology

(PATENT PENDING)

### MODE 1 | Road Tanker Recognition

Confirms *RTR* clamp is connected to road tanker and not other earthed/unearthed objects.

### MODE 2 | Positive Earth Recognition

Confirms positive static earth connection before connecting tanker to earth.

### MODE 3 | Earth Connection Monitoring

Confirms clamp connection and earth connection is good throughout transfer process by ensuring connection resistance does not rise above 10 Ohms.

*For ordering codes and more detailed technical information please refer to product specification sheet.*

The Earth-Rite *RTR*™ Static Earthing System is designed specifically for road tankers with rubber tyres. For dedicated loading/unloading of Rail Cars or other conductive mobile tanks, IBC totes and drums the standard Earth-Rite PLUS system with Single Mode (Earth resistance monitoring) is available. For complete flexibility in mixed loading applications specify the Earth-Rite *RTR*™ with additional Mode Selector Key Switch.



Ex d (ia) IIB T6

**GREEN LIGHT** ✓  
Tri-Mode checks complete - *RTR* permits product transfer

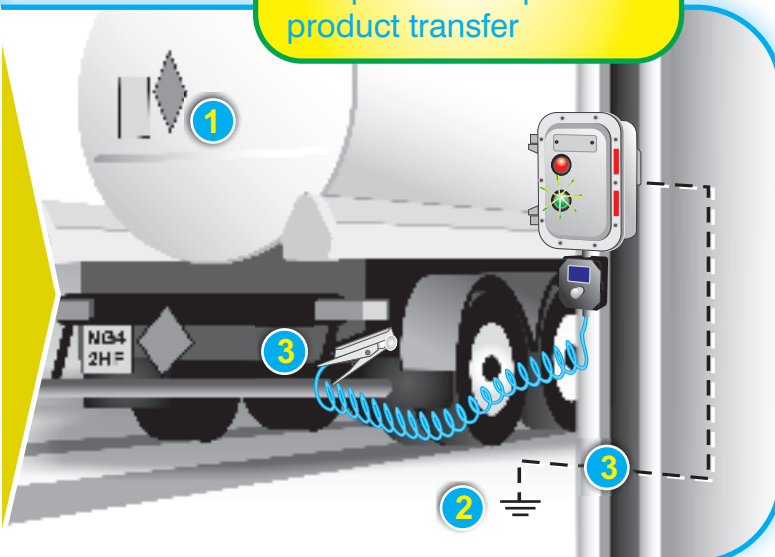

**Reliability** | The *RTR* has been independently tested and approved for mounting in SIL2 rated systems confirming the Earth-Rite's 10 year track record of proven system reliability and performance.

**Flexibility** | The *RTR* can be mounted at remote loading stations and connected to locally verified earth points and can reduce the cost of installation and maintenance.

**Compliance** with NFPA 77 and CENELEC 50404 | The *RTR* enables compliance with the best practice guidelines of NFPA 77 & CENELEC 50404 which recommend that road tankers present in hazardous atmospheres be fully earthed prior to and during the transfer of cargo.



**Cenelectrex**