



ONE AND TWO-FAMILY VIDEO KIT Mod. 956 WITH ARTICO VIDEO DOOR PHONE

Urmet Domus video door phone system Mod. 956 allows single and two-user video systems without coax cable and with a reduced number of wires: 4 common wires + 1 calling wire for each monitor.

The 4" monitor with flat screen does not need any embedding and, as for Urmet Domus traditional video door phone system, the image appears only on the called monitor.

The conversation between the outdoor station and the monitor can take place even if the indoor set has not been called.

The call is electronic bitonal type; the TV camera unit uses a CCD TV camera; the subject is lighted by means of infrared Leds.

The monitor is equipped with a door-release key and 2 additional keys that can be used for any service or as self-insertion key: in this case the system needs an additional wire in conduit.

Block diagram for two family system

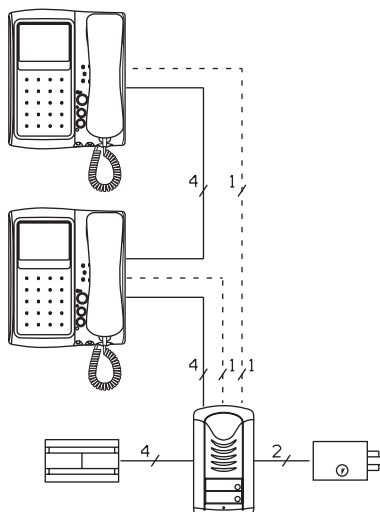

By pressing a button of the push button panel the call is sent to the monitor on which the image appears after 4" about.

By unhooking the handset, the conversation with the video outdoor station can take place.

Monitor lighting is timed (one minute about). Every new call cancels the previous one with timer reset.

EQUIPMENT

The products are the following:

- One-family video door phone kit (230Vac 50Hz) **Ref. 956/31**
Composed by:
 - Smyle Camera with 1 button
 - Artico video door phone with bracket
 - Power supply
- Two-family video door phone kit (230Vac 50Hz) **Ref. 956/32**
Composed by:
 - Smyle Camera with 2 buttons
 - 2 Artico video door phones with bracket
 - Power supply
- One-family video door phone kit (110Vac 60Hz) **Ref. 956/19**
Composed by:
 - Smyle Camera with 1 button
 - Artico video door phone with bracket
 - Power supply
- Two-family video door phone kit (110Vac 60Hz) **Ref. 956/29**
Composed by:
 - Smyle Camera with 2 buttons
 - 2 Artico video door phones with bracket
 - Power supply

ACCESSORIES

- Max 1 Atlantico door phone or **Ref. 1133/35A**
- Max 1 supplementary ringer **Ref. 9854/41**
- Call repeater relay **Ref. 788/52**
- Blue screen **Ref. 1705/102**
- Transformer (230Vac 50Hz) **Ref. 9000/230**
- Transformer (110Vac 60Hz) **Ref. 9000/110**

SPARE PARTS

The possible spare parts for repair are the following:

- Camera **Ref. 956/123**
- Panel with 1 button **Ref. 1729/1**
- Panel with 2 buttons **Ref. 1729/2**
- Power supply **Ref. 956/110**
- Bracket for video door phone **Ref. 1705/955**
- Video door phone (CCIR Version 50Hz) **Ref. 1705/1**
- Video door phone (EIA Version 60Hz) **Ref. 1705/18**
- Grey screen **Ref. 1705/101**

TECHNICAL FEATURES

VIDEO DOOR PHONE

- Power supply: **18Vdc max**
- Consumption: **600 mA max**
- Kinescope: **4" Flat**
- Resolution: **450 TV lines**
- Video input: **1Vpp differential**
- Ringer: **electronic two-tone**
- Dimensions: **200 x 241 x 83mm**

CAMERA UNIT

- Camera: **CCD**
- Lighting: **infrared LED**
- Power supply: **18Vdc max**
- Timer: **approximately 45"**
- Video output: **1Vpp differential**
- Dimensions: **185 x 99 x 35mm**

POWER SUPPLY

- Power supply: **110/230Vac ± 10% 50/60Hz**
- Power: **38VA**
- Secondary unit: **12Vac 1A + 1A (timed 30%)**
18Vdc 1A (timed 10%)
- Protections: **with PTC thermal switch PTC (*)**
- Dimensions: **96 x 126 x 75mm**
- Dissipated power after 1 average working hour: **4,2W**

Length of 126 mm corresponds to seven 18 mm modules in accordance with DIN 43880 standards.

Weight: **1,1Kg**

(*) To restore the power supply if the PTC thermal switch trips following overload or short-circuit, power the unit down for 60 seconds or longer.

WIRE SECTIONS

FROM TV CAMERA UNIT TO MONITORS

Function	Wires	m	50m	100m	200m
Video power supply	R1	S/mm ²	0,5	0,75	1,5
Video power supply	R2	S/mm ²	0,5	0,75	1,5
Video signal	A	S/mm ²	0,35	0,35	0,35 twisted
Video signal	B	S/mm ²	0,35	0,35	0,35
Call	C1 - C2	S/mm ²	0,35	0,5	0,75
Self-insertion call	AI	S/mm ²	0,35	0,35	0,35



ONE AND TWO-FAMILY VIDEO KIT Mod. 956 WITH ARTICO VIDEO DOOR PHONE

urmet
DOMUS

CAMERA UNIT

Distances are between the TV camera unit and the last monitor. Up to 100m it is possible to use normal wires; for longer distances, up to 200m, twist the wires A and B.

FROM POWER SUPPLY TO TV CAMERA UNIT

Function	Wires	m	50m	100m
Power supply 12V~	~12	S/mm ²	0,5	0,75
Power supply 12V~	~0	S/mm ²	0,5	0,75
Power supply 18V ==	+18	S/mm ²	0,35	0,35
Power supply 18V ==	R1	S/mm ²	0,35	0,35

CAMERA UNIT

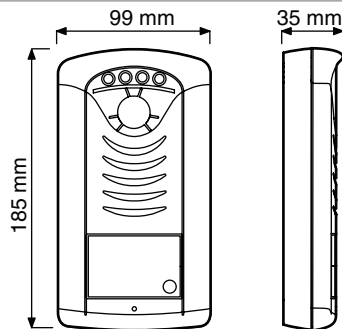

The camera unit is fitted in a Smyle panel. The unit includes:

- Camera with solid state CCD sensor.
- Infrared LED lights.
- Front panel with 1 or 2 buttons.
- Electronic circuits.
- Name tag light LED.

The internal and external sound volumes can be adjusted by operating on the proper controls.

INSTALLATION

- Remove the name tag light circuit.

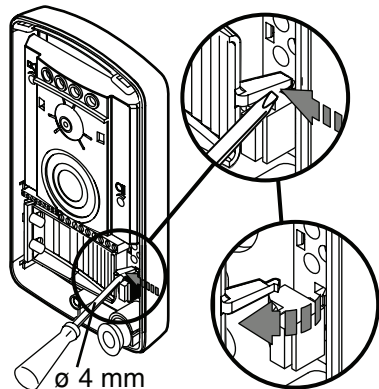

- Extract the door unit from the base.

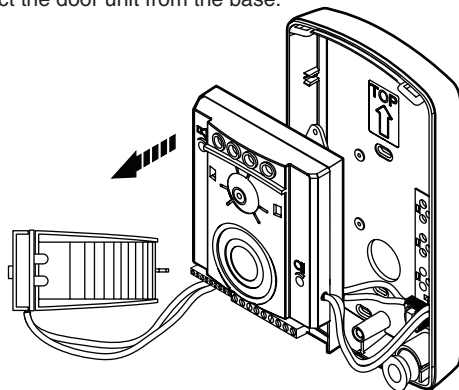

- Fasten the base onto a flat wall at the height shown in the figure using either the bolts provided or a 503 box.

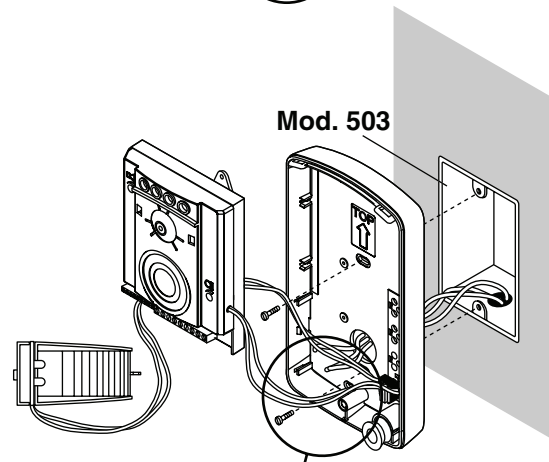
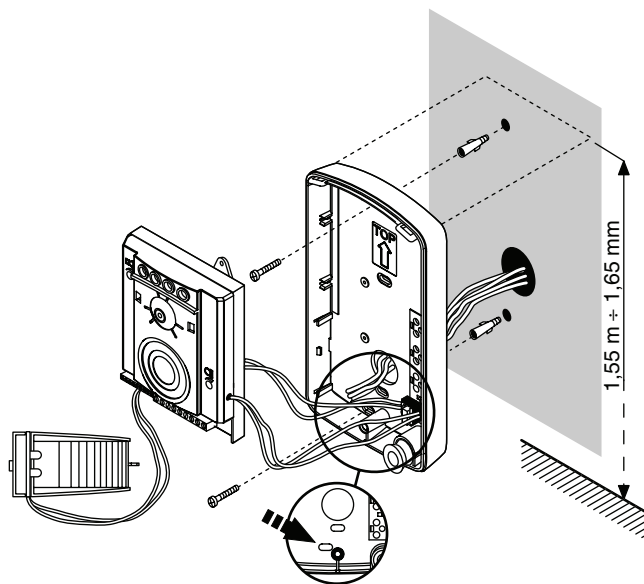

- Insert the door unit into the compartment in the based and connect the wires (it is advisable to have approximately 40-45mm of wire protruding from the wall).

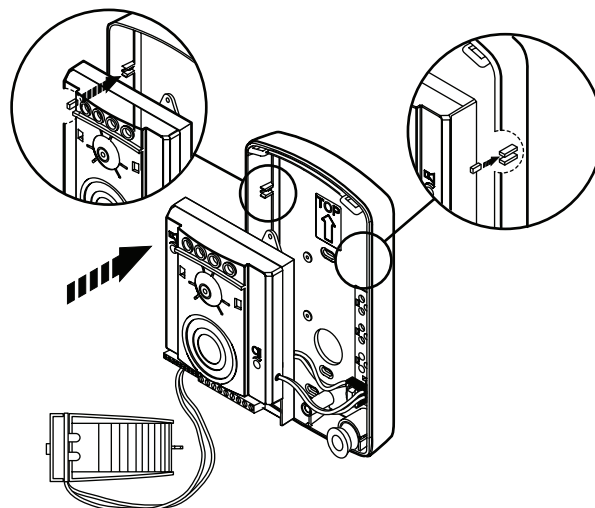



- Fasten the name tag light circuit making the wires pass under neath the support; then adjust volume and camera position.

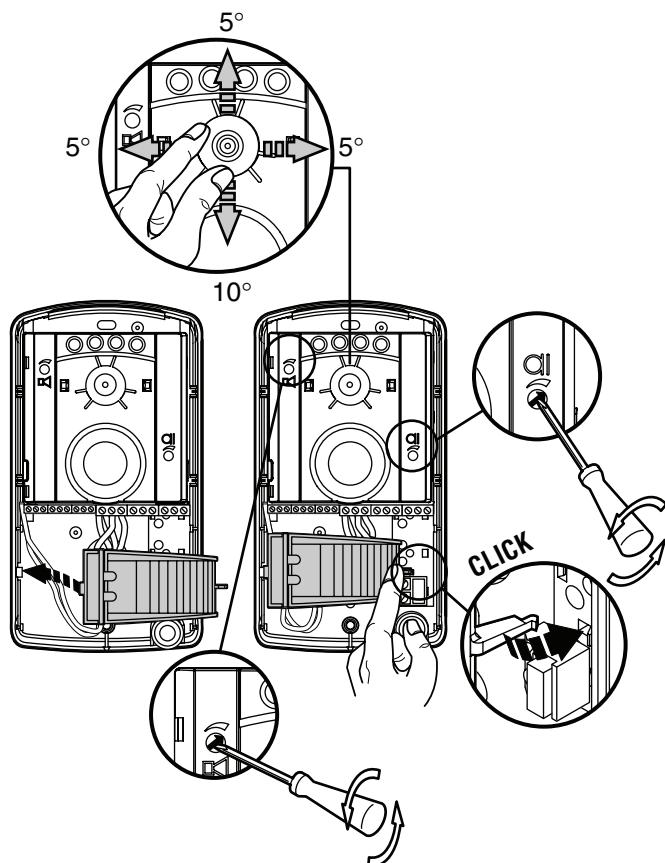

NOTE: volume is calibrated to optimal values during production. Change the settings when needed only.

- Write the name on the name tag and insert in the housing.

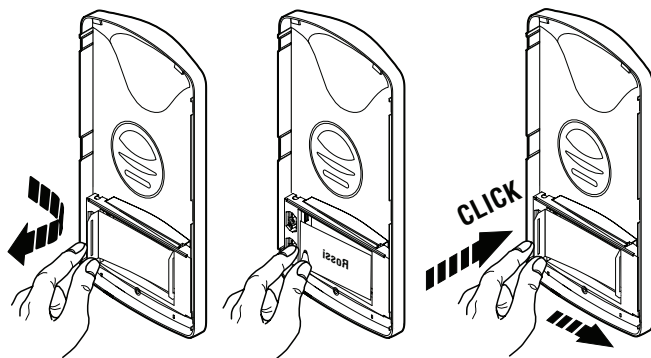
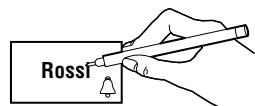

- Insert the front part of the panel on the base and fasten it with the socket head screw using the wrench (2mm) provided.

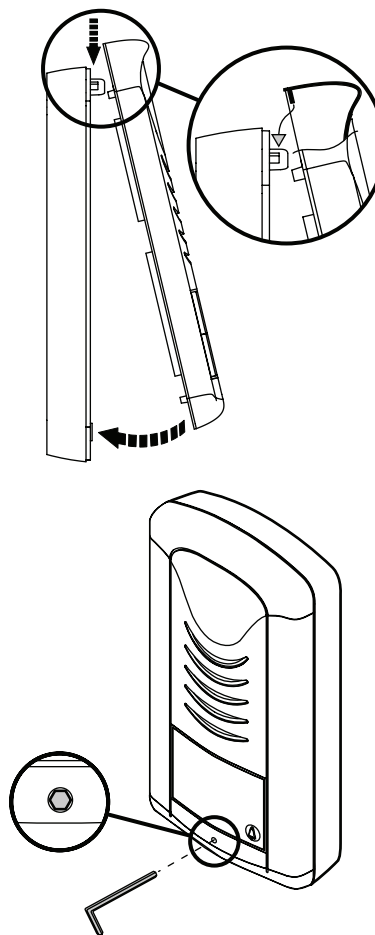



VIDEO DOOR PHONE

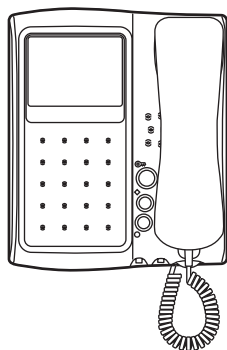

The main characteristics of the video door phone are:

- Flat 4" video module
- Adjustable and mutable call volume. The adjustment wheel appears red when the volume is muted.

Note: when volume is set to "MUTE" the video door phone will not ring but the video module will light up.

- Door opener button.
- Service buttons (◇ and ○).
- Adjustable brightness and contrast.

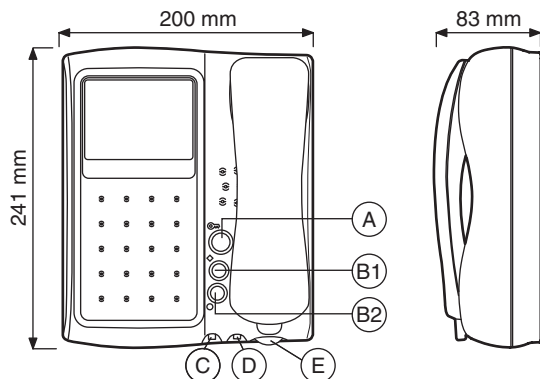

- A** Door opener button.
B1 Auxiliary button: used for special functions.
B2 Auxiliary button: used for special functions.
C Contrast/colour adjustment control.
D Brightness adjustment control.
E Call volume control and adjustment: turn the knob as far as it will go (red part visible) to mute the call tone ("MUTE" function).

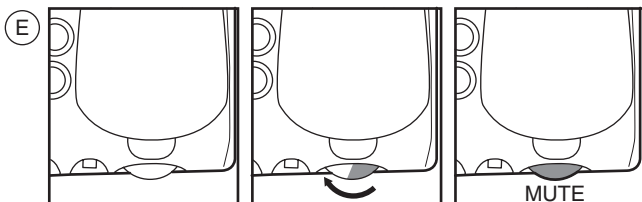

INSTALLATION

- 1) Prepare the conduit so that it terminates at the infeed hole provided.
- 2) Use 4 plugs to fasten the bracket to the wall at the height from the floor indicated.
- 3) Connect the wires to the specific terminals.
- 4) Extract the fastening hook **A**.
- 5) Insert the video door phone in the bracket.
- 6) Fasten the video door phone in place pushing hook **A** inwards.

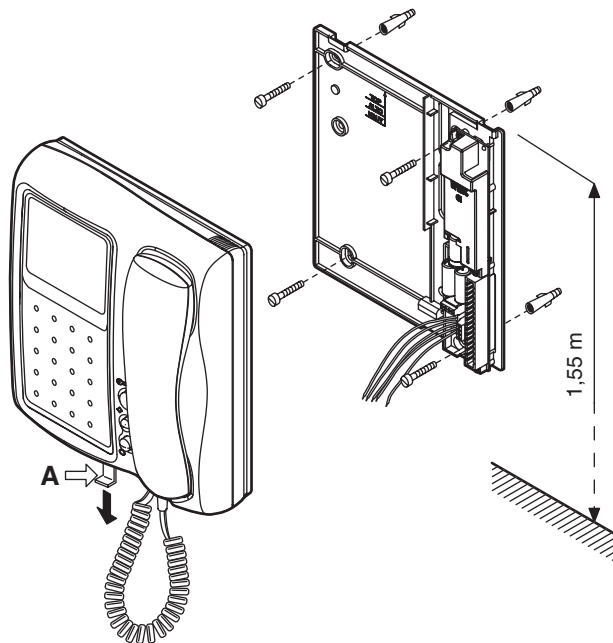

POWER SUPPLY

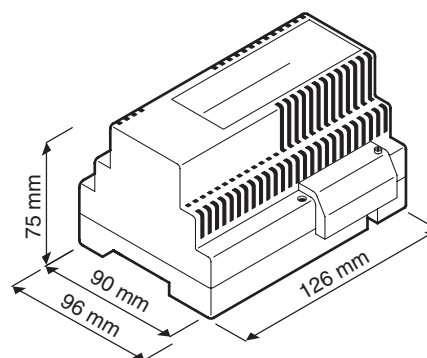

The power supply unit provides power to the entire system. It is connected to the monitor by means of two wires. It can be wall-fitted or fitted on DIN bar.

The power supply unit must be installed in dry places protected from weather conditions.

126mm in length correspond to seven 18mm modules, as per DIN 43880 standard.



SV102-2082C

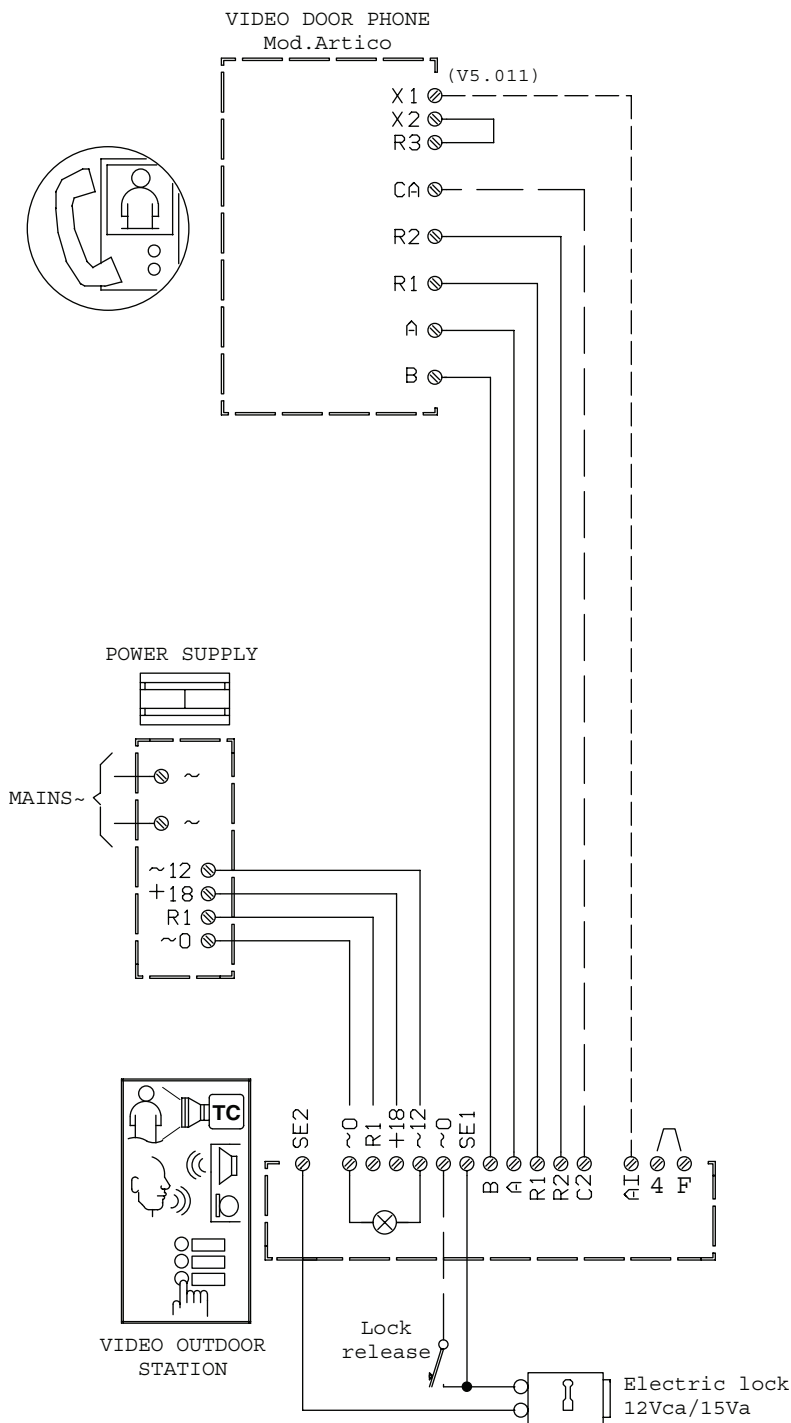

V5.011 Connect the wire for Self-insert function. In this case make a jumper between terminals X2 and R3.



SV102-2081B

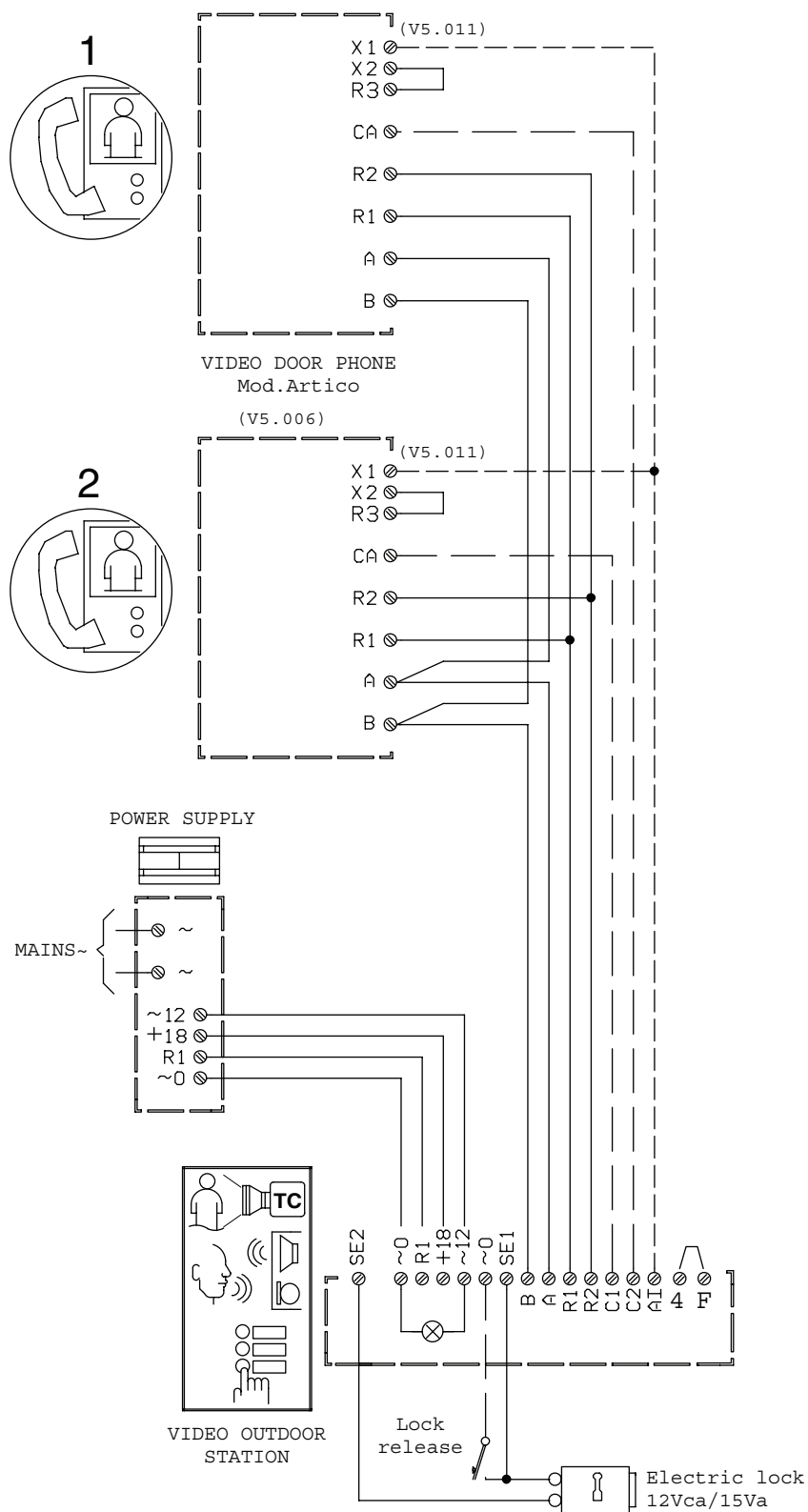

V5.006 The maximum distance between devices is 50 metres.

V5.011 Connect the wire for Self-insert function. In this case make a jumper between terminals X2 and R3.



SV102-2135C

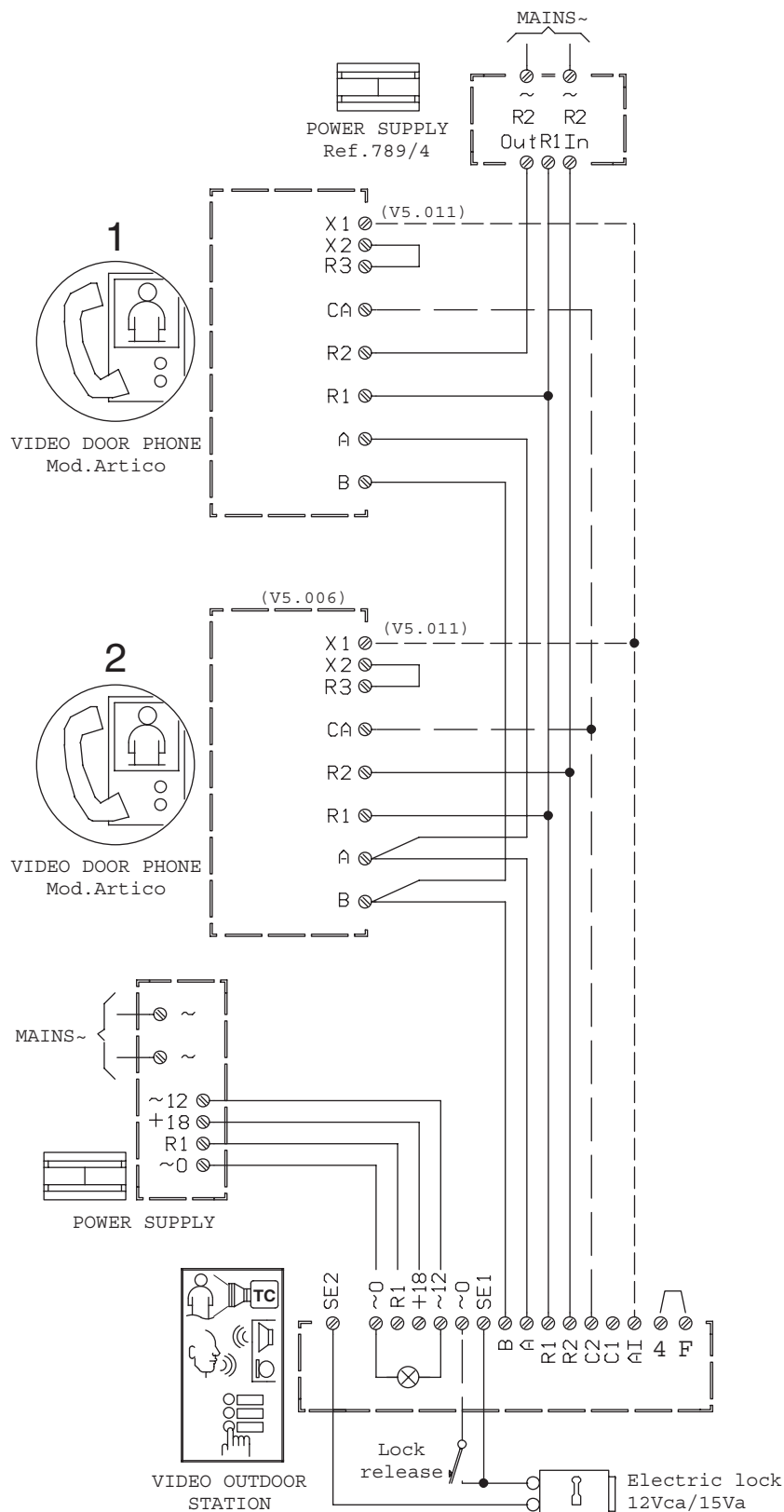

V5.006 The maximum distance between devices is 50 metres.

V5.011 Connect the wire for Self-insert function. In this case make a jumper between terminals X2 and R3.